

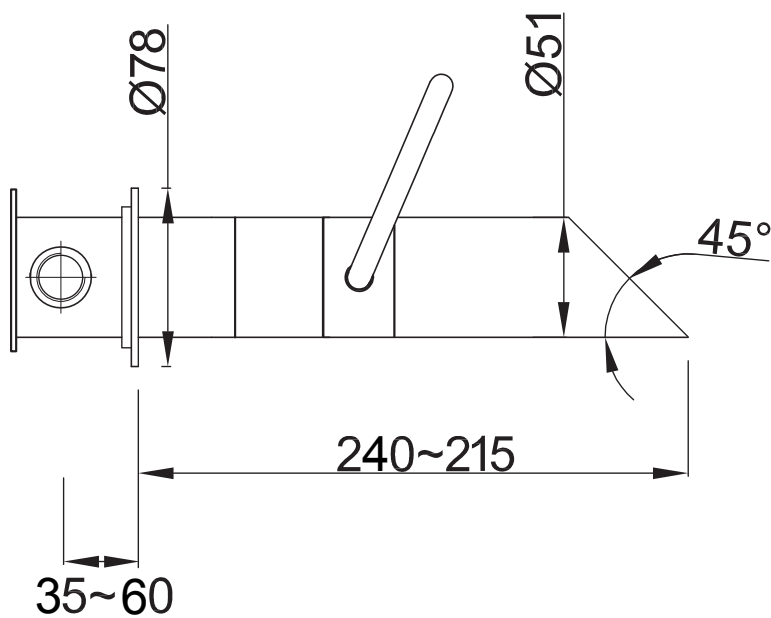

JEE-O pure wall basin mixer specifications

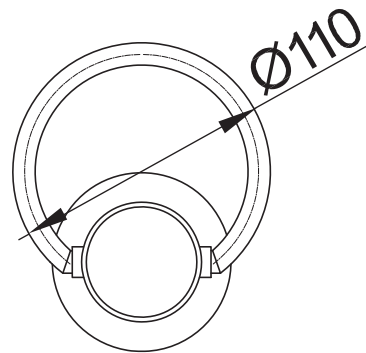

middle off

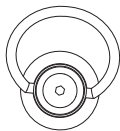

right water flow

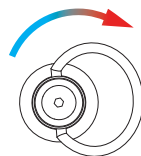

Article code:

300-1500

● Brushed

300-1501

● Polished

Material:

Stainless Steel r304

Cleaning instructions:

download JEE-O shower and taps manual on our website: www.jee-o.com

Cartridge:

Kerox ceramic mixing mechanism (progressive), item code 005-0201

Flow at water of 38°C /100,4°F:

9L p/m at 3bar pressure

Connection:

Thread:

2 x G 1/2" (ø15mm / 0.6")
British Standard Pipe (BSP)

Dimension package:

Total weight:

Package weight:

L 38 x W 27 x H 16 cm
2.6 kg
0.4 kg

7 year warranty - The general conditions can be found on our website: www.jee-o.com/downloads

HS code:

84818011900

Approvals:

SLS BS EN 817