

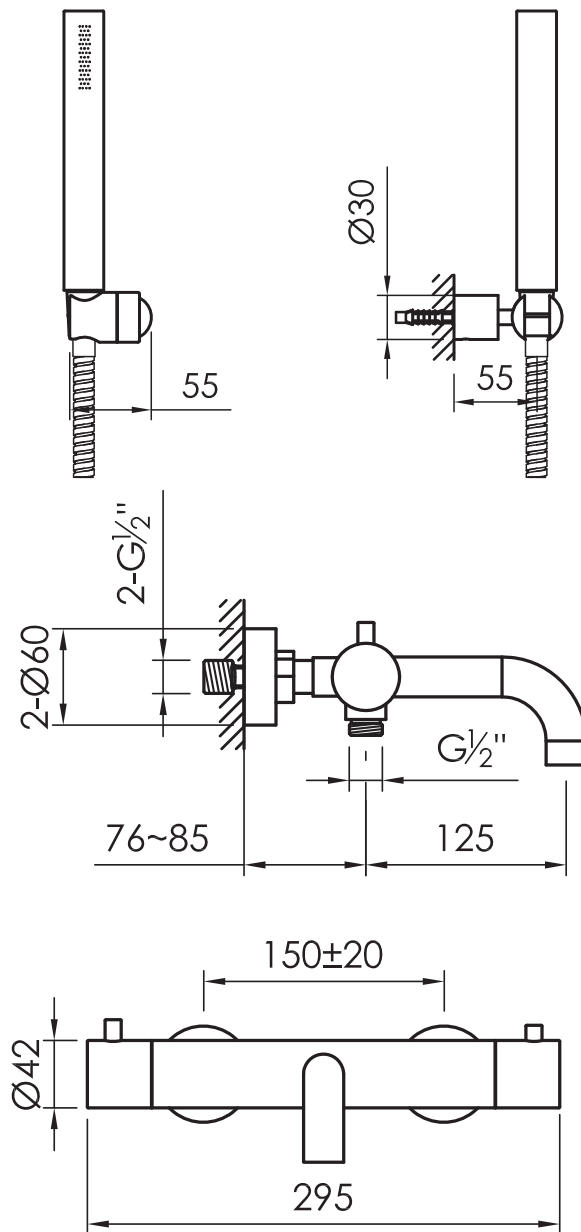

JEE-O slimline wall bath mixer thermostatic



Article code:

800-3300

● Brushed

800-3303

● Structured black

800-3304

● PVD coated bronze

800-3305

● PVD coated matt gold

800-3309

● PVD coated dark steel

Material:

Stainless Steel r304

Cleaning instructions:

download JEE-O shower and taps manual on our website: www.jee-o.com

Cartridges:

Vernet mixing mechanism (thermostatic), item code 005-0501 and Flühs ceramic diverter mechanism, item code 005-0603

Flow at water of 38°:

11l p/m at 3Bar pressure

Pressure:

Recommended working pressure 3Bar

Connection:

Thread:

2 x G 1/2" (ø15mm / 0.6")
British Standard Pipe (BSP)

Dimensions package:

L28 x W 38 x H 15 cm

Total weight:

3.9 kg

Package weight:

0.16 kg

7 year warranty – The general conditions can be found on our website: www.jee-o.com/downloads

HS code:

84818011900

JEE-O slimline slimline wall bath mixer thermostatic | November 2023

Models are subject to change and specs may contain typographical errors
Slight variations in the aesthetic appearance of the product, including the color, may occur after exposure to external influences such as sunlight, pollution or harmful chemicals